

# NATIONAL INDUSTRIES

## 11000

### ROUND BAR



SEC.No.	A	Wt.(kg/Mtr.)	Wt.(kg/12')
11000	20.0	0.848	3.060-3.300
11001	36.00	2.745	9.800-10.500
11002	38.00	3.060	11.000-11.800
11003	40.00	3.390	12.200-13.000
11004	50.00	5.290	19.250-20.250
11005	57.00	6.885	25.000-26.200
11006	65.00	8.950	32.500-34.000
11007	75.00	11.920	43.500-45.000
11008	9.30	0.183	0.670-0.700
11009	9.85	0.205	0.750-0.800
11010	11.3	0.270	0.990-1.100
11011	14.20	0.427	1.550-1.650
11012	15.00	0.477	1.750-1.850
11013	18.00	0.687	2.500-2.600
11014	25.00	1.325	4.850-5.000

## BAR

## 11351

### SQ. TUBE

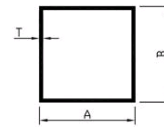

SEC.No.	A	B	T	Wt.(kg/Mtr.)	Wt.(kg/12')
11351	23.00	23.00	0.55	0.125	0.450-0.600
11352	24.00	24.00	1.00	0.245	0.900-1.000
11353	38.10	38.10	1.40	0.554	2.000-2.100
11354	38.10	38.10	2.00	0.765	2.600-2.950
11355	19.00	19.00	2.00	0.367	1.300-1.450
11356	50.00	50.00	1.20	0.628	2.300-2.500

## DIFFERENT TUBE

## 11401

### RECT. TUBE

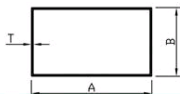

SEC.No.	A	B	T	Wt.(kg/Mtr.)	Wt.(kg/12')
11401	36.00	24.00	0.69	0.204	0.750-0.850
11402	36.00	24.00	0.79	0.232	0.850-1.000
11403	36.00	24.00	0.88	0.273	1.000-1.200
11404	36.00	24.00	1.09	0.327	1.200-1.400
11405	36.00	24.00	1.25	0.382	1.400-1.600
11406	36.00	24.00	1.52	0.464	1.700-1.900
11407	46.50	23.50	0.70	0.232	0.850-1.000
11408	46.50	23.50	0.81	0.273	1.000-1.150
11409	48.00	24.00	0.90	0.327	1.200-1.350
11410	48.00	24.00	1.00	0.368	1.350-1.500
11411	48.00	24.00	1.12	0.409	1.500-1.700
11412	48.00	24.00	1.25	0.464	1.700-1.900
11413	48.00	24.00	1.42	0.519	1.900-2.100
11414	48.00	24.00	1.60	0.600	2.200-2.400
11415	48.00	24.00	2.00	0.750	2.750-3.000
11416	50.80	25.40	2.00	0.790	2.890-3.000
11417	61.50	37.50	0.84	0.440	1.600-1.750
11418	62.00	24.00	0.75	0.327	1.200-1.350
11419	62.00	24.00	0.85	0.368	1.350-1.450
11420	62.00	24.00	1.00	0.437	1.600-1.700
11421	62.00	24.00	1.12	0.491	1.800-2.000
11422	62.00	24.00	1.40	0.600	2.200-2.400
11423	63.00	38.00	0.73	0.382	1.400-1.550
11424	63.00	38.00	0.82	0.464	1.700-1.900
11425	63.00	38.00	0.95	0.519	1.900-2.100
11426	63.00	38.00	1.10	0.573	2.100-2.400

## DIFFERENT TUBE

## 11426

11426	63.00	38.00	1.10	0.573	2.100-2.400
11427	63.00	38.00	1.40	0.737	2.700-2.900
11428	63.00	38.00	1.70	0.887	3.250-3.450
11429	63.00	38.00	1.95	0.792	3.800-4.200
11430	75.00	25.00	0.65	0.409	1.500-1.700
11431	75.00	25.00	8.00	3.633	13.300-13.400
11432	81.25	38.10	0.85	0.519	1.900-2.100
11433	81.25	38.10	0.95	0.573	2.100-2.300
11434	81.25	38.10	1.40	0.792	3.100-3.400
11435	95.00	24.00	0.81	0.491	1.800-2.000
11436	95.00	24.00	1.0	0.601	2.200-2.400
11437	95.00	24.00	1.15	0.710	2.600-2.800
11438	46.20	23.20	0.65	0.238	0.870-1.000
11438	121.90	23.94	1.09	0.850	3.000-3.300
11439	125.00	35.00	2.00	1.684	6.000-6.300

## DIFFERENT TUBE

# NATIONAL INDUSTRIES

**11886**

SEC. NO:-11886

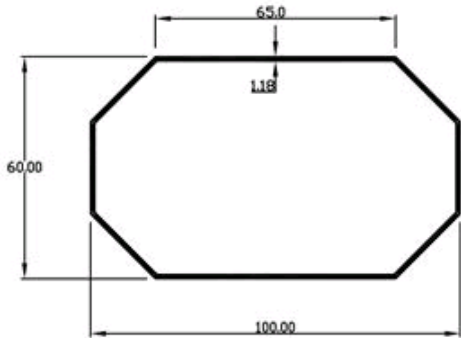

WEIGHT:- 3.200-3.500 kg/12'

**DIFFERENT TUBE**

**11891**

SEC. NO:-11891

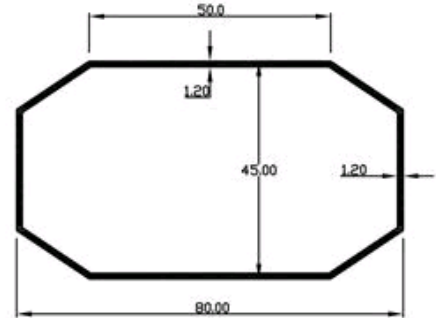

WEIGHT:- 2.500-2.800 kg/12'

**DIFFERENT TUBE**

**12676**

SQUARE BAR



SEC.No.	A	B	Wt.(kg/Mtr.)	Wt.(kg/12')
12676	12.00	12.00	0.387	1.420-1.520
12677	38.00	38.00	3.907	14.300-14.500
12678	41.00	41.00	4.538	16.600-16.800

**BAR**

**12691**

FLAT BAR

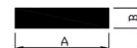

SEC.No.	A	B	Wt.(kg/Mtr.)	Wt.(kg/12')
12691	25.0	3.00	0.204	0.750-0.850
12692	25.0	5.00	0.337	1.200-1.400
12693	25.0	6.00	0.409	1.500-1.700
12694	25.0	10.0	0.680	2.500-2.700
12695	28.0	6.00	0.450	1.650-1.850
12696	40.0	6.0	0.655	2.400-2.600
12697	40.0	10.0	1.092	4.000-4.200
12698	50.0	6.0	0.819	3.000-3.200
12699	50.0	10.0	1.350	4.950-5.150
12700	60.0	3.00	0.480	1.750-1.950
12701	75.0	5.0	1.000	3.700-3.900
12702	75.0	6.0	1.215	4.450-4.650
12703	100.0	6.0	1.612	5.900-6.100
12704	31.5	5.0	0.425	1.500-1.650
12705	35.0	3.00	0.283	1.036-1.236
12706	12.0	5.15	0.166	0.609-0.800
12707	125.0	2.70	0.910	3.200-3.500
12708	125.0	4.00	1.350	4.900-5.200
12709	25.40	5.50	0.374	1.250-1.450
12710	25.40	10.0	0.683	2.400-2.600
12711	40.00	10.0	1.077	3.850-4.050
12712	50.00	10.0	1.346	4.800-5.000
12713	50.00	12.0	1.616	5.800-6.000
12714	60.00	10.0	1.616	5.800-6.000
12715	100.0	10.0	2.693	9.750-9.950

**BAR**

# NATIONAL INDUSTRIES

12776

SEC. NO:-12776

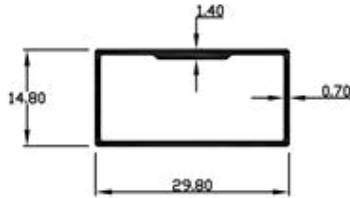

WEIGHT:- 0.600-0.800 kg/12'

DIFFERENT TUBE

12931

HEX BAR



SEC.No.	A	Wt.(kg/12')
12931	9.52	0.775
12932	17.35	2.580
12933	18.70	2.950

BAR

13156

SEC. NO:-13156

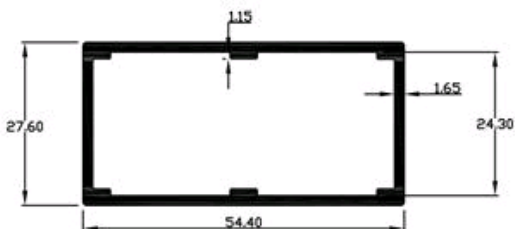

WEIGHT:-2.800 kg/12'

DIFFERENT TUBE

13161

SEC. NO:-13161

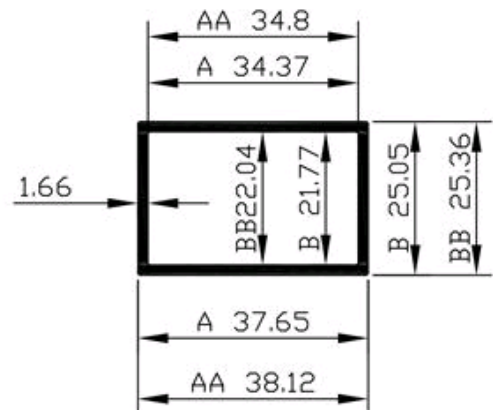

WEIGHT:-1.800-2.100 kg/12'

DIFFERENT TUBE

# NATIONAL INDUSTRIES

14801

SEC. NO:-14801

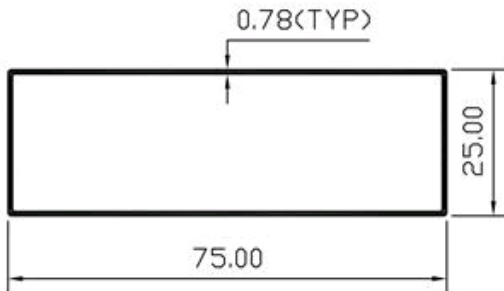

WEIGHT:- 1.515 kg/12'

DIFFERENT TUBE

14806

SEC. NO:-14806

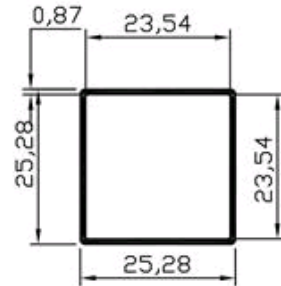

WEIGHT:- 0.836 kg/12'

DIFFERENT TUBE

15531

SEC. NO:-15531

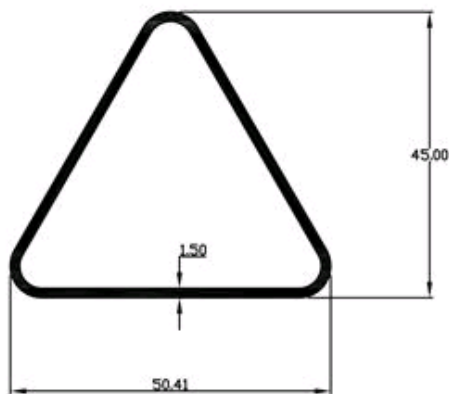

WEIGHT:- 2.107 kg/12'

DIFFERENT TUBE

15856

SEC. NO:-15856

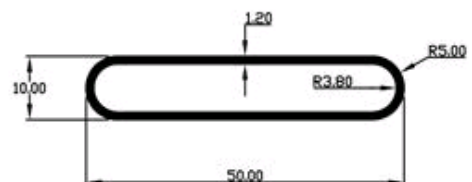

WEIGHT:- 1.276 kg/12'

DIFFERENT TUBE

# NATIONAL INDUSTRIES

15876

SEC. NO:-15876

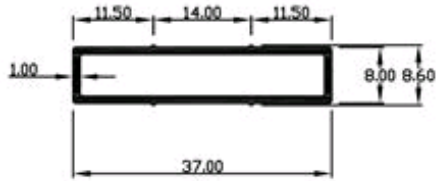

WEIGHT:- 0.856 kg/12'

DIFFERENT TUBE

15927

SEC. NO:-15927

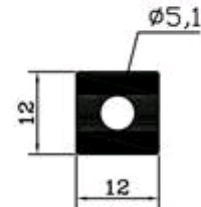

WEIGHT:- 1.200 kg/12'

BAR

15944

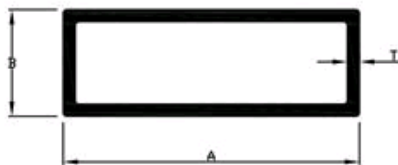

DIFFERENT TUBE

15951

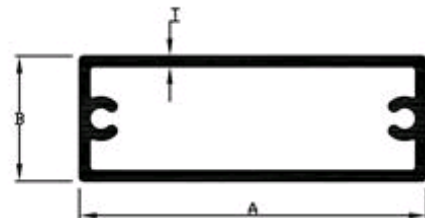

DIFFERENT TUBE

# NATIONAL INDUSTRIES

16044

SEC. NO:-16044

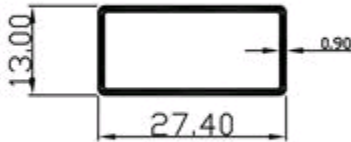

WEIGHT:- 0.679 kg/12'

DIFFERENT TUBE

16045

SEC. NO:-16045

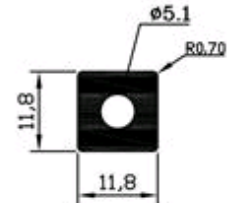

WEIGHT:- 1.170 kg/12'

BAR

16154

SEC. NO:-16154

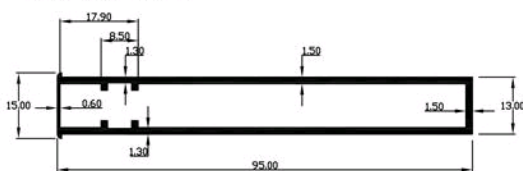

WEIGHT:- 3.100 kg/12'

DIFFERENT TUBE

16155

SEC. NO:-16155

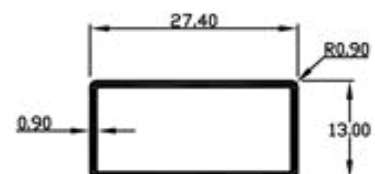

WEIGHT:- 0.680 kg/12'

DIFFERENT TUBE

# NATIONAL INDUSTRIES

16158

SEC. NO:-16158



WEIGHT:- 1.100 kg/12'

DIFFERENT TUBE

16159

SEC. NO:-16159

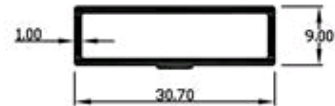

WEIGHT:- 0.770 kg/12'

DIFFERENT TUBE

16282

SEC. NO:-16282

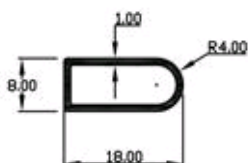

WEIGHT:- 0.444 kg/12'

DIFFERENT TUBE

16306

SEC. NO:-16306

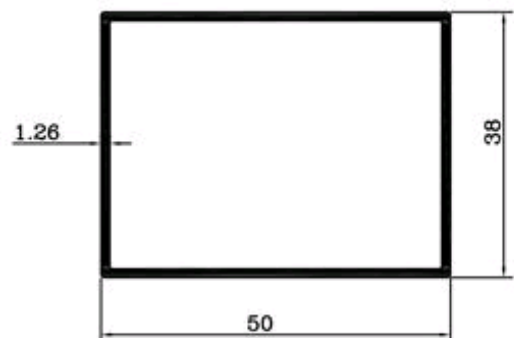

WEIGHT:- 2.122 kg/12'

DIFFERENT TUBE

# NATIONAL INDUSTRIES

16348

SEC. NO:-16348 N-395



WEIGHT:- 1.431 kg/12'

BAR

16409

SEC. NO:-16409

IND-35

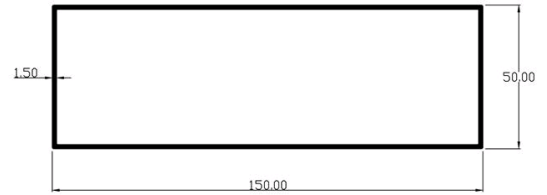

WEIGHT:- 5.838 kg/12'

DIFFERENT TUBE

16410

SEC. NO:-16410

IND-52



WEIGHT:- 3.646 kg/12'

DIFFERENT TUBE

16474

SEC. NO:-16474

N-444(M)

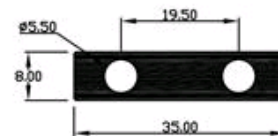

WEIGHT:- 2.296 kg/12'

BAR



# NATIONAL INDUSTRIES

16525

SEC. NO:-16525

N-482

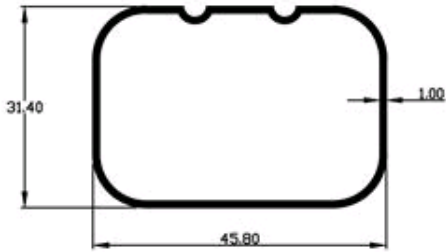

WEIGHT:- 1.384 kg/12'

DIFFERENT TUBE

16526

SEC. NO:-16526

N-481

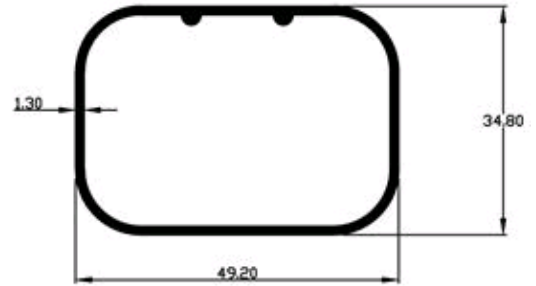

WEIGHT:- 1.960 kg/12'

DIFFERENT TUBE

16529

SEC. NO:-16529

N-512

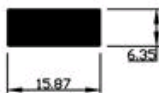

WEIGHT:- 0.995 kg/12'

BAR

16564

SEC. NO:-16564

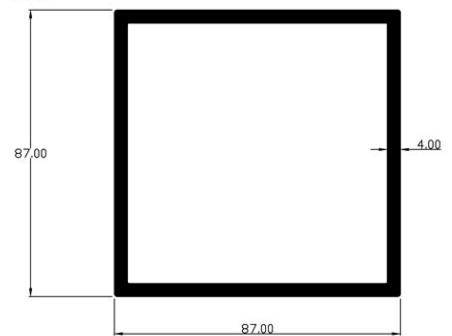

WEIGHT:- 13.119 kg/12'

DIFFERENT TUBE

# NATIONAL INDUSTRIES

16577

SEC. NO:-16577

N-464

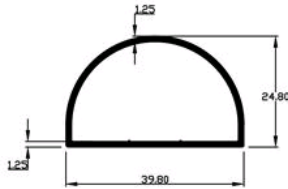

WEIGHT:- 1.331 kg/12'

DIFFERENT TUBE

16630

SEC. NO:-16630

N-570

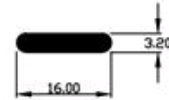

WEIGHT:- 0.484 kg/12'

BAR

16721

SEC. NO:-16721

N-593



WEIGHT:- 4.653 kg/12'

BAR

16759

SEC. NO:-16759

N

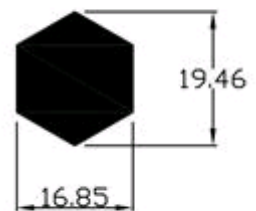

WEIGHT:- 2.430 kg/12'

BAR

# NATIONAL INDUSTRIES

16760

SEC. NO:-16760

N-621

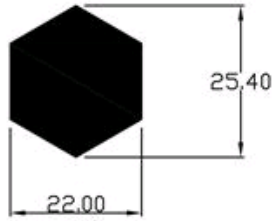

WEIGHT:- 4.141 kg/12'

BAR

16761

SEC. NO:-16761

N-622



WEIGHT:- 0.194 kg/12'

BAR

NATIONAL INDUSTRIES